

MODEL AND SIGNIFICANCE

S	CB8	-	63A	400	1/2/3/4P	PV
Enterprise code	Design Number		Rated Current	Rated Voltage	Pole	PV system

GENERAL PARAMETERS

- Suitable for protection of electrical installations against [short-current] and Over current
- Specially design for solar inverter output
- Indication window and optional remote-signaling contact helps users to know the status of device
- The current-carrying parts are all made of copper, low temperature rise
- Unique shape and high recognition
- The whole machine can pass the salt spray test within 48 hours

DIMENSIONS (MM)

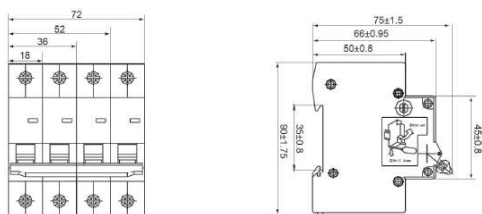

INSTALLATION PRECAUTIONS

- In a medium without explosion risk and free of gases and dust(including conductive dust) sufficient to corrode metal and destroy insulation
- In the condition with no snow erosion
- It can be installed horizontally and vertically
- The magnetic field of the installation position shall not exceed 5 times the geomagnetic field in any direction
- It should not be installed in flammable and explosive places
- There should be no significant impact and vibration at the installation place

AC CIRCUIT BREAKER

- SCB8-63/230VAC/1P
- SCB8-63/400VAC/2P
- SCB8-63/400VAC/3P
- SCB8-63/400VAC/4P



ELECTRICAL PARAMETERS

Product Model	SCB8-63			
Pole	1P	2P	3P	4P
Rated Operational Voltage/Ue(V)	230/400VAC	400VAC	400VAC	400VAC
Rated Operational Current/In(A)	6, 10, 16, 20, 25, 32, 40, 50, 63A			
Frequency(Hz)	50/60HZ			
Ultimate Breaking Capacity/Icu(kA)	6kA			
Rated Breaking Capacity/Ics(kA)	6kA			
Max. Impulse Current/Iimp(A)	6kA			
Mechanical Life	20000			
Electrical Life	4000			
Fire-retardant Enclosure Level	V0			
Device Width x Height (mm)	18*79.5*77.5	36*79.5*77.5	54*79.5*77.5	72*79.5*77.5
Method of Mounting	DIN RAIL			
Mounting	Easy installed and fastening onto 35mm device rail(DIN)			
Terminal Capacity	25mm ²			
Fastening Torque of Terminals	3N			
Location	Indoor or in the Water-proof Box			
Ambient Temperature	-5°C To 50°C			
Altitude	≤2000m			
Relative Humidity	90%			
Weight(per pole)	0.12kg			
Pollution Level	2			
Installation Class	II/III			